

## CYLINDER BLOCK (II) ASSEMBLY

B3E011010300E05

1. Assemble in the order indicated in the table.

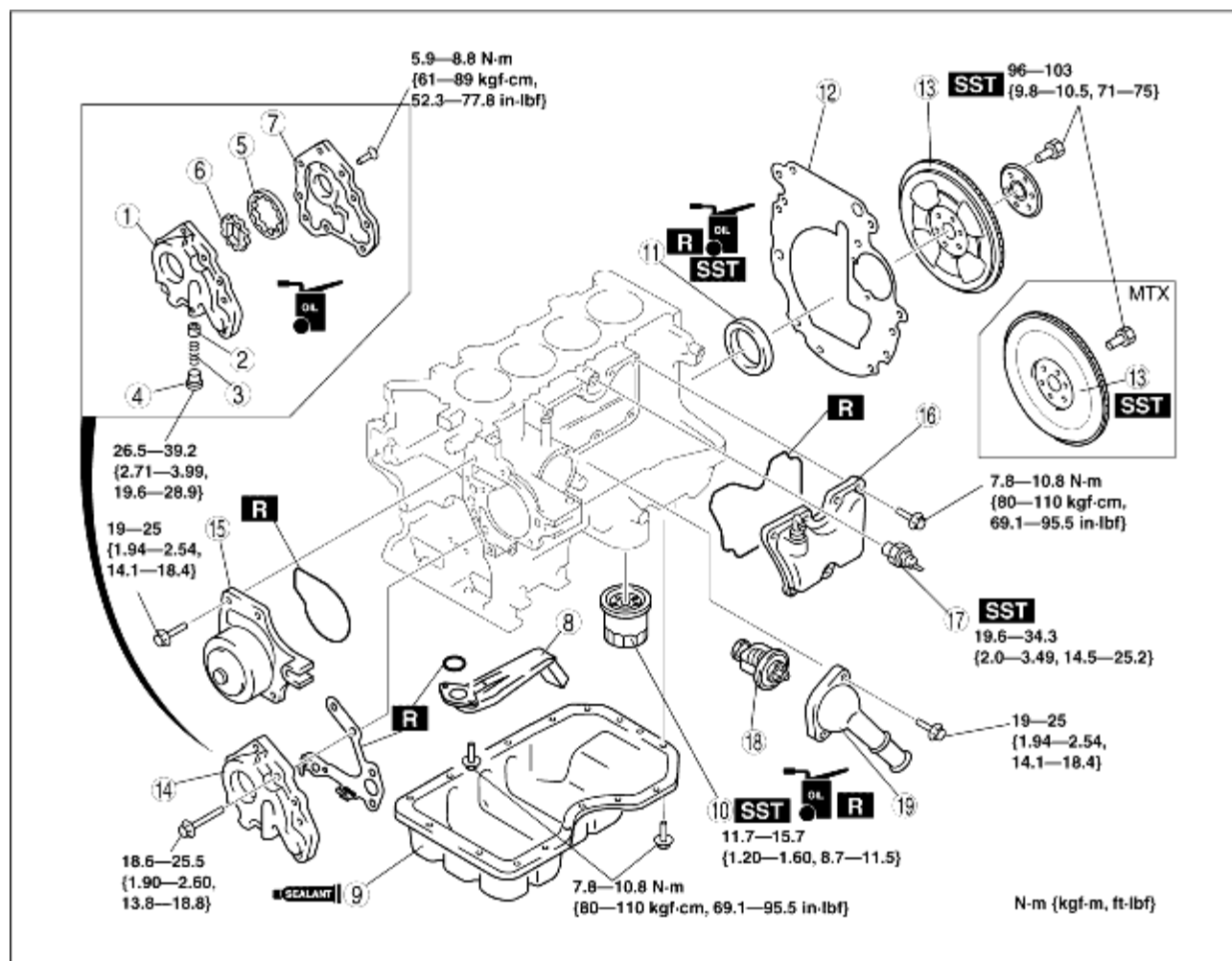

B3E0110E014

1	Oil pump body
2	Control plunger
3	Plunger spring
4	Plunger plug
5	Outer rotor (See <a href="#">Inner Rotor, Outer Rotor Assembly Note</a> )
6	Inner rotor (See <a href="#">Inner Rotor, Outer Rotor Assembly Note</a> )
7	Oil pump cover
8	Oil strainer
9	Oil pan (See <a href="#">Oil Pan Assembly Note</a> )
10	Oil filter (See <a href="#">Oil Filter Assembly Note</a> )
	Rear oil seal

11	(See <a href="#">Rear Oil Seal Assembly Note</a> )
12	End plate
13	Drive plate (ATX), flywheel (MTX) (See <a href="#">Drive Plate (ATX), Flywheel (MTX) Assembly Note</a> )
14	Oil pump (See <a href="#">Oil Pump Assembly Note</a> )
15	Water pump
16	Oil separator
17	Knock sensor (See <a href="#">Knock Sensor Assembly Note</a> )
18	Thermostat
19	Thermostat cover

## Inner Rotor, Outer Rotor Assembly Note

1. Assemble the inner rotor and the outer rotor with the punch marks aligned.

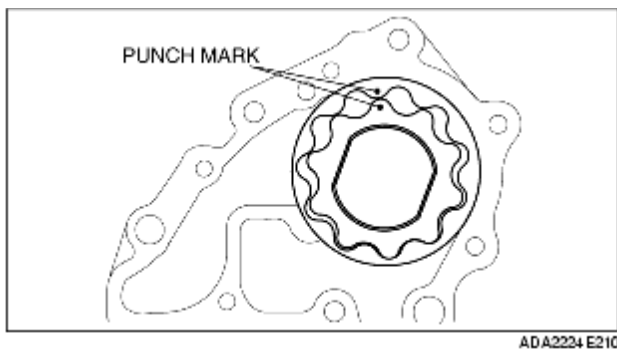

## Oil Pan Assembly Note

1. Apply silicone sealant as shown in the figure.

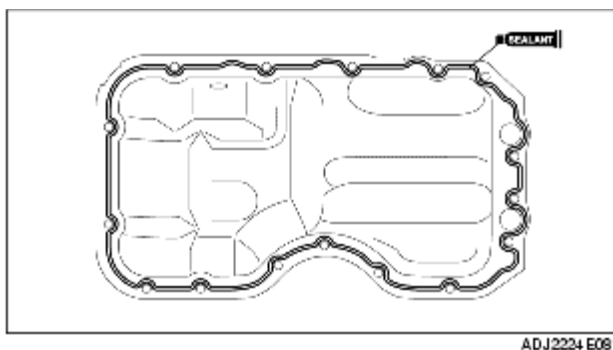

**Diameter**  
**2.0-6.0 mm {0.08-0.23 in}**

2. Tighten the oil pan installation bolts in the order shown in the figure.

**Tightening torque**  
 7.8-10.8 N·m {80-110kgf·cm, 69.1-95.5 in·lbf}

## Oil Filter Assembly Note

1. Install the oil filter using the **SST**.

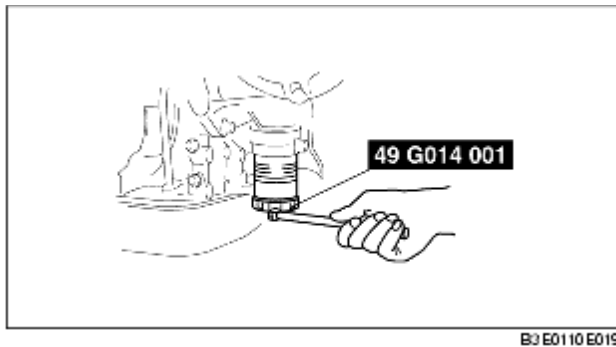

**Tightening torque**  
 11.7-15.7 N·m {1.20-1.60 kgf·m, 8.7-11.5 ft·lbf}

## Rear Oil Seal Assembly Note

1. Apply clean engine oil to a new rear oil seal.
2. Insert the rear oil seal to the cylinder block by hand.
3. Install the rear oil seal using the **SST**.

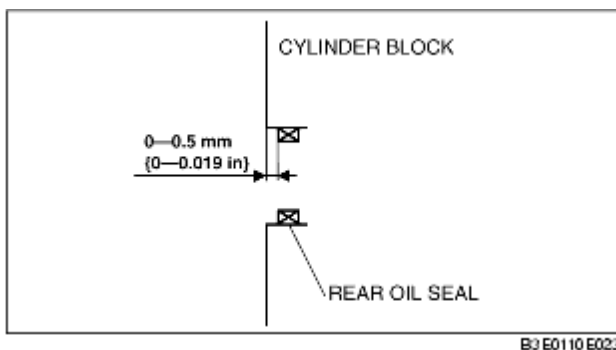
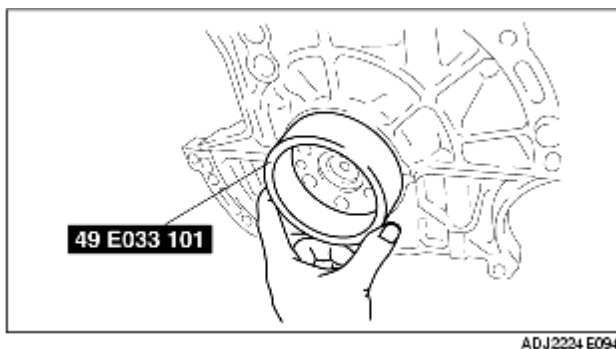

## Drive Plate (ATX), Flywheel (MTX) Assembly Note

1. Lock the drive plate (ATX) or flywheel (MTX) against rotation using the **SST**.

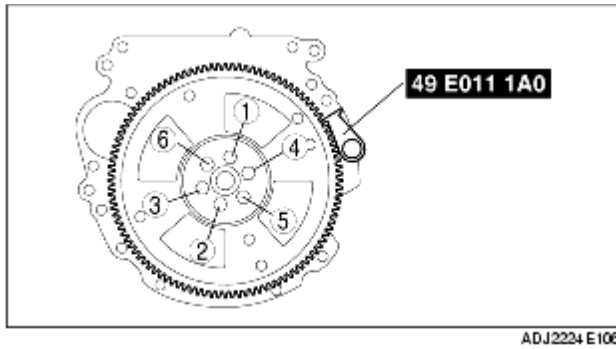

2. Tighten the flywheel installation bolts in two to three passes in the order shown in the figure.

## Oil Pump Assembly Note

1. Install the gasket to the oil pump.

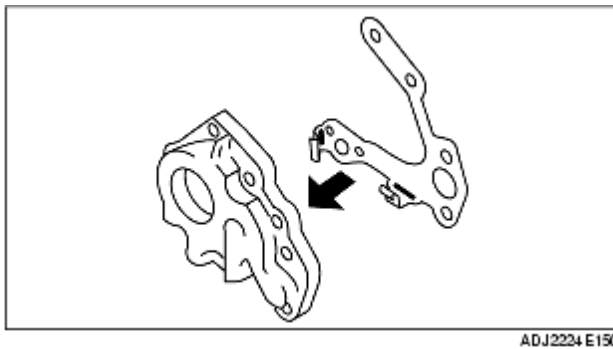

2. Install the oil pump and gasket as a single unit.

## Knock Sensor Assembly Note

1. Install the knock sensor using the **SST**.

